

AGREEMENT

I (we) agree that the club holding this event has the right to refuse this entry for cause which the club shall deem sufficient. In consideration of the acceptance of this entry and of the holding of this event and of the opportunity to have the dog judged and to win prizes, ribbons, or trophies, I (we) agree to hold the AKC, the event-giving club, their members, directors, governors, officers, agents, superintendents or event secretary and the owner and/or lessor of the premises and any provider of services that are necessary to hold this event and any employees or volunteers of the aforementioned parties, and any AKC approved judge, judging at this event, harmless from any claim for loss or injury which may be alleged to have been caused directly or indirectly to any person or thing by the act of this dog while in or about the event premises or grounds or near any entrance thereto, and I (we) personally assume all responsibility and liability for any such claim; and I (we) further agree to hold the aforementioned parties harmless from any claim for loss, injury or damage to this dog.

Additionally, I (we) hereby assume the sole responsibility for and agree to indemnify, defend and save the aforementioned parties harmless from any and all loss and expense (including legal fees) by reason of the liability imposed by law upon any of the aforementioned parties for damage because of bodily injuries, including death at any time resulting therefrom, sustained by any person or persons, including myself (ourselves), or on account of damage to property, arising out of or in consequence of my (our) participation in this event, however such, injuries, death or property damage may be caused, and whether or not the same may have been caused or may be alleged to have been caused by the negligence of the aforementioned parties or any of their employees, agents, or any other persons. **I (WE) AGREE THAT ANY CAUSE OF ACTION, CONTROVERSY OR CLAIM ARISING OUT OF OR RELATED TO THE ENTRY, EXHIBITION OR ATTENDANCE AT THE EVENT BETWEEN THE AKC AND THE EVENT-GIVING CLUB (UNLESS OTHERWISE STATED IN ITS PREMIUM LIST) MYSELF (OURSELVES) OR AS TO THE CONSTRUCTION, INTERPRETATION AND EFFECT OF THIS AGREEMENT SHALL BE SETTLED BY ARBITRATION PURSUANT TO THE APPLICABLE RULES OF THE AMERICAN ARBITRATION ASSOCIATION. HOWEVER, PRIOR TO ARBITRATION ALL APPLICABLE AKC BYLAWS, RULES, REGULATIONS AND PROCEDURES MUST FIRST BE FOLLOWED AS SET FORTH IN THE AKC CHARTER AND BYLAWS, RULES, REGULATIONS, PUBLISHED POLICIES AND GUIDELINES.**

INSTRUCTIONS

- (Variety) if you are entering a dog of breed in which there are varieties for show purposes, please designate the particular variety you are entering, i.e., Cocker Spaniel (solid color black, ASCOB, parti-color), Beagles (not exceeding 13 in., over 13 in. but not exceeding 15 in.), Dachshunds (longhaired, smooth, wirehaired), Collies (rough, smooth), Bull Terriers (colored, white), Manchester Terriers (standard, toy), Chihuahuas (smooth coat, long coat), English Toy Spaniels (King Charles and Ruby, Blenheim and Prince Charles), Poodles (toy, miniature, standard).
- The following categories of dogs may be entered and shown in Best of Breed competition: Dogs that are Champions of Record and dogs which, according to their owners' records, have completed the requirements for a championship, but whose championships are unconfirmed. The showing of unconfirmed Champions in Best of Breed competition is limited to a period of 90 days from the date of the show where the dog completed the requirements for a championship.
- (Event Class) Consult the classification in this premium list. If the event class in which you are entering your dog is divided, then, in addition to designating the class, specify the particular division of the class in which you are entering your dog, i.e. age division, color division, weight division.
- A dog must be entered in the name of the person who actually owned it at the time entries for an event closed. If a registered dog has been acquired by a new owner it must be entered in the name of its new owner in any event for which entries closed after the date of acquirement, regardless of whether the new owner has received the registration certificate indicating that the dog is recorded in his name. State on entry form whether transfer application has been mailed to the AKC. (For complete rules, refer to Chapter 11, Section 3.)

Premium List



ST. PAUL DOG TRAINING CLUB, INC.

Licensed by the American Kennel Club

Pure-Bred & All American Dogs Welcome

Friday, January 6, 2012

All AKC Eligible Breeds Obedience Trial

AKC Event # 2012179102
all breed, indoors, unbenched, unlimited entry
SHOW HOURS: 7:00 am - 6:00 pm

ST. PAUL DOG TRAINING CLUB Southview Shopping Center

219 - 13th Avenue South, South St. Paul, MN 55075
Phone #: 651-455-2431 Emergency Phone #: 651-455-2296

TRIAL SECRETARY

Dog Shows By Design

Cindy O'Hare, Event Secretary
8221 Griffith Ave. NW - Maple Lake, Minnesota 55358
Phone . . . 320-963-7705 - Fax . . . 320-963-6087
Web Page . . . www.dogshowsbydesign.com

AMERICAN KENNEL CLUB CERTIFICATION



AMERICAN
KENNEL CLUB™

Permission has been granted by the
American Kennel Club for the holding of this event under
American Kennel Club rules and regulations.
James P. Crowley, Secretary

ENTRIES CLOSE - 12:00 NOON, WEDNESDAY, DECEMBER 21, 2011

After which time entries cannot be accepted, cancelled, altered or substituted except as provided for in American Kennel Club *Rules Applying to Dog Shows*.

CLUB OFFICERS & COMMITTEES

OFFICERS

President.....Karl Blakely
 Vice President.....Phil Rustad
 Treasurer.....Marcia Koukkari
 Secretary.....Bev Olson

2121- 189th Ave, Andover, MN 55304 ...763-213-8293

BOARD OF DIRECTORS

Ann Decker Ron Halling Greg Kirmeier
 Mary Phelps Kristi Portogue.....Richard Wood
 Marge Peters (Board Member Emeritus)

OBEDIENCE TRIAL COMMITTEE

Marcia Koukkari, Trial Chairperson

PO Box 148, Afton, MN 55001

and all Officers and Members of the Board of Directors

Chief Ring Steward..... Ron Halling
 Awards..... Cindy Rustad

VETERINARIAN (ON CALL)

Jim Winsor, DVM

7131 Cahill Avenue, Inver Grove Heights, MN 55075 - (651) 451-4404

Driving Directions to Veterinarian's Office . . .
 From the St. Paul Dog Training Center, turn right on Southview Blvd. and go East . . . turn right on 7th Avenue and go South . . . continue on Cahill Avenue and go South to 7131 Cahill Avenue.

JUDGES

<u>Friday, January 6, 2012</u>	<u>Obedience Trial Classes</u>
Mr Charles W Anderson	Novice A
Ms Susan P Emerson	Novice B
Mr Charles W Anderson	Beginner Novice A
Mr Charles W Anderson	Beginner Novice B
Mrs JoAnna Yund	Graduate Novice
Mrs JoAnna Yund	Open A
Mr Charles W Anderson	Open B
Ms Susan P Emerson	Graduate Open
Ms Susan P Emerson	Utility A
Mrs JoAnna Yund	Utility B
Ms Susan P Emerson	Versatility

Mr Charles W Anderson (5304).....5946 W Bald Eagle Blvd, White Bear Lake, MN 55110-6433
 Ms Susan P Emerson (18865)..... 9080-235th St W, Lakeville, MN 55044-7877
 Mrs JoAnna Yund (3603).....4047 Sheridan Avenue South, Minneapolis, MN 55416

NOTE: The show site will NOT be available for set up on Thursday, January 5, 2012.

OFFICIAL AMERICAN KENNEL CLUB ENTRY FORM

St. Paul Dog Training Club, Inc.
 219 - 13th Avenue South, South St. Paul, MN 55075

Friday, January 6, 2012

		FRIDAY
Obedience - First Entry (each day)	\$25.00	[]
Obedience - Additional Entry (for the same dog . . . each day)	\$18.00	[]
The above entry fees include \$0.50 AKC Recording Fee & \$3.00 Event Service Fee for each recordable entry of the same dog in single entry classes		

ENTRIES CLOSE . . . 12 NOON . . . WEDNESDAY . . . DECEMBER 21, 2011

Make Checks payable to: **CINDY O'HARE, SHOW SECRETARY, DSBD**
 Mail to: **Cindy O'Hare, 8221 Griffith Ave NW, Maple Lake, MN 55358**

Conditional, unsigned, or incomplete entries or entries received without fees will not be accepted. Telephone, telegraph & email entries are not accepted. All cancellations must be written and received by the Show Secretary before the closing date.

I ENCLOSE \$ for entry fees I ENCLOSE \$ for Catalogs

Please typewrite or print with black ink. IMPORTANT - Read carefully instructions on reverse side before filling out. Numbers in boxes indicate sections of the instructions relevant to the information needed in that box.

BREED	VARIETY [1]	SEX (circle one) Dog Bitch
OBEDIENCE TRIAL REGULAR CLASSES . . . offered for each trial (check classes to be entered)		OB Jmp Hgt
<input type="checkbox"/> Novice A <input type="checkbox"/> Novice B <input type="checkbox"/> Open A <input type="checkbox"/> Open B <input type="checkbox"/> Utility A <input type="checkbox"/> Utility B		
OBEDIENCE TRIAL OPTIONAL TITLING CLASSES . . . offered for each trial (check classes to be entered)		
<input type="checkbox"/> Beginner Novice A <input type="checkbox"/> Beginner Novice B <input type="checkbox"/> Grad Novice <input type="checkbox"/> Grad Open <input type="checkbox"/> Versatility		

FULL NAME OF DOG

<input type="checkbox"/> AKC REG. NO. (Enter number here)	DATE OF BIRTH
<input type="checkbox"/> C.P. NO.	PLACE OF BIRTH <input type="checkbox"/> USA <input type="checkbox"/> Canada <input type="checkbox"/> Foreign (Do not print in catalog)
<input type="checkbox"/> I.L.P./PAL NO.	
<input type="checkbox"/> FOREIGN REG. NO. & COUNTRY	

BREEDER

SIRE

DAM

ACTUAL OWNER(S) [4] _____ (Please Print)
OWNER'S ADDRESS _____
CITY _____ STATE _____ ZIP _____

NAME OF OWNER'S AGENT (IF ANY) AT THE SHOW

I CERTIFY that I am the actual owner of the dog, or that I am the duly authorized agent of the actual owner whose name I have entered above. In consideration of the acceptance of this entry, I (we) agree to abide by the rules and regulations of The American Kennel Club in effect at the time of this event, and by any additional rules and regulations appearing in the premium list for this event, and further agree to be bound by the "Agreement" printed on the reverse side of this entry form. I (we) certify and represent that the dog entered is not a hazard to persons or other dogs. This entry is submitted for acceptance on the foregoing representation and Agreement. I (we) agree to conduct myself (ourselves) in accordance with all such Rules and Regulations (including all provisions applying to discipline) and to abide by any decisions made in accord with them. I (we) certify and represent that the dog entered is not a hazard to persons or other dogs.

SIGNATURE of owner or his agent
 duly authorized to make this entry _____

TELEPHONE# _____

EMAIL _____

AGREEMENT

I (we) agree that the club holding this event has the right to refuse this entry for cause which the club shall deem sufficient. In consideration of the acceptance of this entry and of the holding of this event and of the opportunity to have the dog judged and to win prizes, ribbons, or trophies, I (we) agree to hold the AKC, the event-giving club, their members, directors, governors, officers, agents, superintendents or event secretary and the owner and/or lessor of the premises and any provider of services that are necessary to hold this event and any employees or volunteers of the aforementioned parties, and any AKC approved judge, judging at this event, harmless from any claim for loss or injury which may be alleged to have been caused directly or indirectly to any person or thing by the act of this dog while in or about the event premises or grounds or near any entrance thereto, and I (we) personally assume all responsibility and liability for any such claim; and I (we) further agree to hold the aforementioned parties harmless from any claim for loss, injury or damage to this dog.

Additionally, I (we) hereby assume the sole responsibility for and agree to indemnify, defend and save the aforementioned parties harmless from any and all loss and expense (including legal fees) by reason of the liability imposed by law upon any of the aforementioned parties for damage because of bodily injuries, including death at any time resulting therefrom, sustained by any person or persons, including myself (ourselves), or on account of damage to property, arising out of or in consequence of my (our) participation in this event, however such, injuries, death or property damage may be caused, and whether or not the same may have been caused or may be alleged to have been caused by the negligence of the aforementioned parties or any of their employees, agents, or any other persons. **I (WE) AGREE THAT ANY CAUSE OF ACTION, CONTROVERSY OR CLAIM ARISING OUT OF OR RELATED TO THE ENTRY, EXHIBITION OR ATTENDANCE AT THE EVENT BETWEEN THE AKC AND THE EVENT-GIVING CLUB (UNLESS OTHERWISE STATED IN ITS PREMIUM LIST) MYSELF (OURSELVES) OR AS TO THE CONSTRUCTION, INTERPRETATION AND EFFECT OF THIS AGREEMENT SHALL BE SETTLED BY ARBITRATION PURSUANT TO THE APPLICABLE RULES OF THE AMERICAN ARBITRATION ASSOCIATION. HOWEVER, PRIOR TO ARBITRATION ALL APPLICABLE AKC BYLAWS, RULES, REGULATIONS AND PROCEDURES MUST FIRST BE FOLLOWED AS SET FORTH IN THE AKC CHARTER AND BYLAWS, RULES, REGULATIONS, PUBLISHED POLICIES AND GUIDELINES.**

INSTRUCTIONS

- (Variety) if you are entering a dog of breed in which there are varieties for show purposes, please designate the particular variety you are entering, i.e., Cocker Spaniel (solid color black, ASCOB, parti-color), Beagles (not exceeding 13 in., over 13 in. but not exceeding 15 in.), Dachshunds (longhaired, smooth, wirehaired), Collies (rough, smooth), Bull Terriers (colored, white), Manchester Terriers (standard, toy), Chihuahuas (smooth coat, long coat), English Toy Spaniels (King Charles and Ruby, Blenheim and Prince Charles), Poodles (toy, miniature, standard).
- The following categories of dogs may be entered and shown in Best of Breed competition: Dogs that are Champions of Record and dogs which, according to their owners' records, have completed the requirements for a championship, but whose championships are unconfirmed. The showing of unconfirmed Champions in Best of Breed competition is limited to a period of 90 days from the date of the show where the dog completed the requirements for a championship.
- (Event Class) Consult the classification in this premium list. If the event class in which you are entering your dog is divided, then, in addition to designating the class, specify the particular division of the class in which you are entering your dog, i.e. age division, color division, weight division.
- A dog must be entered in the name of the person who actually owned it at the time entries for an event closed. If a registered dog has been acquired by a new owner it must be entered in the name of its new owner in any event for which entries closed after the date of acquirement, regardless of whether the new owner has received the registration certificate indicating that the dog is recorded in his name. State on entry form whether transfer application has been mailed to the AKC. (For complete rules, refer to Chapter 11, Section 3.)

EXHIBITORS . . . PLEASE NOTE

TELEPHONE, EMAIL, AND UNSIGNED ENTRIES CANNOT BE ACCEPTED. Entries not on Official AKC Entry Forms and photocopies of entry forms without Agreement and Rules on the reverse side of the Official AKC Entry Form are NOT ACCEPTABLE.

MAIL ALL ENTRIES WITH FEES to Cindy O'Hare, DSBD, 8221 Griffith Ave NW, Maple Lake, MN 55358. Entries received without fees will not be accepted. Acknowledgment of entries will be made as soon as practicable with entry confirmation notice and judging program. Should such acknowledgment not be received by the exhibitor within a reasonable time, please notify the Dog Shows By Design.

MAKE ALL CHECKS AND MONEY ORDERS PAYABLE TO . . . CINDY O'HARE, DSBD

CANADIAN EXHIBITORS must make fees payable in U.S. FUNDS. Please mail checks or money orders with entries.

FAX ENTRIES FOR THIS SHOW WILL BE ACCEPTED UP TO THE CLOSING TIME AND DATE. The Fax Entry number is 320-963-6087. Official AKC Entry Forms must be used and both sides of the entry form must be transmitted. Credit Card issuer's name (**Visa or Master Card only**), credit card number, expiration date, cardholder's name, and signature must appear on a cover page. As of January 1, 2004, the Fax Entry System fee is \$2.50 per class per show in addition to entry fees. **All entries, regardless of method of submission, using a credit card as a method of payment will be processed through the Fax Entry System and are charged the additional fee.** Proof of transmission is not proof of receipt of a legible or complete transmission.

POST DATED CHECKS, RETURNED CHECKS AND DECLINED CREDIT CARDS do not constitute a valid entry fee. A service fee of \$25 will be added to the amount of each returned check or declined card.

NO ENTRY SHALL BE MADE AND NO ENTRY SHALL BE ACCEPTED WHICH SPECIFIES ANY CONDITIONS AS TO ITS ACCEPTANCE.

ENTRY FEES SHALL NOT BE REFUNDED in the event that a dog is absent, disqualified, excused by Veterinarian or Judge, or barred from competition by action of Show Committee. If because of riots, civil disturbances or other acts beyond the control of the management it is impossible to open or to complete the show, no refund of entry fee will be made. Extreme weather conditions, such as, but not limited to snow storms, hurricanes, lightning, extreme heat, must be considered for the health and safety of the dogs, exhibitors and spectators. The well-being of dogs, exhibitors and spectators is of paramount importance and, in the event it is necessary to cancel or stop the show before completion, no refund of entry fee will be made.

NO REFUND FOR DUPLICATE ENTRIES. Every effort to find all duplicate entries will be made; however, if the entry has been processed, no refund will be made.

THIS CLUB DOES NOT AGREE TO ARBITRATE CLAIMS as set forth on the Official AKC Entry Form for these events.

ERRORS ON ENTRY BLANKS. Owners are responsible for errors in making out entry forms, whoever may make such errors, and no entry fee will be refunded in event of such errors or cancellation of entries after the published closing date.

DOGS MAY ARRIVE any time prior to their scheduled time of judging. Dogs not required for further judging will be excused.

JUDGES WILL NOT WAIT FOR ANY DOG HOLDING UP A CLASS. Owners or agents alone are responsible for the presence of their dogs in the judging ring when their classes are called to be judged.

ALL DOGS PRESENT MUST BE HELD ON LEASH OR CONFINED TO THEIR CRATES except when being judged.

CLASS CASH PRIZES will be paid in the ring to the person showing the dog. Claims for prize money must be made in the ring before the judging of that Show is over, and the Secretary advised at once. The Secretary and show-giving Club disclaim any liability for cash prizes after the judging of the breed is over.

ALL TROPHIES must be claimed at the show . . . If not, they become the property of the Show Giving Club. **NO TROPHIES** will be mailed.

THE SHOW SPONSORING CLUBS RESERVE THE RIGHT to substitute trophies with ones of equal or greater value.

MANAGEMENT IS NOT RESPONSIBLE for the loss of, damage to, or death of any dog exhibited, or for the possessions of any participant, whether the result of accident or any other cause. It is expressly understood that every dog at the show is in the care and custody and control of his owner or handler during the entire time the dog is on the show premises.

THE ST. PAUL DOG TRAINING CLUB, INC., THE SHOW SECRETARY, THEIR AGENTS, EMPLOYEES, ETC., assume no responsibility for any loss, damage or injury sustained by spectators, exhibitors, handlers, their employees or children, etc., or to any of their dogs or property. Entrants and spectators to this show do so entirely at their own risk.

THIS SHOW IS GOVERNED BY THE AMERICAN KENNEL CLUB. Exhibitors should read the AKC agreement on the entry blank in the Premium List.

RUNOFFS: Runoff for High Combined will not be performed until the completion of Utility A, Utility B and Open B and the awarding of those classes and final tabulation by the Show Secretary. Runoff for High in Trial will be performed after the awarding of all Regular Classes and final tabulation by the Show Secretary.

IMPORTANT NOTICE:

EXHIBITORS SHOULD FOLLOW THEIR VETERINARIAN'S RECOMMENDATION TO ASSURE THEIR DOGS ARE FREE OF INTERNAL AND EXTERNAL PARASITES, ANY COMMUNICABLE DISEASES, AND HAVE APPROPRIATE VACCINATIONS.

PROOF OF CURRENT RABIES VACCINATION MUST BE IN THE POSSESSION OF EXHIBITORS OR HANDLERS FOR ALL DOGS AT THESE TRIALS.

OBEDIENCE TRIAL CLASSES

OBEDIENCE TRIAL REGULAR CLASSES

Novice A Novice B Open A Open B Utility A Utility B

OBEDIENCE TRIAL TITLING CLASSES

Beginner Novice A.....Beginner Novice B
Graduate NoviceGraduate Open.....Versatility

MOVE-UPS . . . For these trials will be accepted, according to the provisions stated in "American Kennel Club, Obedience **REFUND OF ENTRY FEES** minus \$10.00 per event, will be given to the entrants of bitches in this trial, upon written certification by a licensed veterinarian to the effect that the bitch in question is in season on the day of the trial, if received one half hour before start of all judging on the trial date.

CATALOGS

Trial Catalogs may be ordered with your entry . . . **\$4.00 per copy** . . . and picked-up the day of the Trial. A very limited number of catalogs will be available for purchase at the Trial . . . **\$5.00 per copy**.

ENTRY FEE PER TRIAL . . . (EACH DAY IS A SEPARATE AKC EVENT)

First entry (*Obedience Trials Classes*).....\$25.00
Additional entry of same dog (*Obedience Trials Classes*).....\$18.00
The above entry fees include \$0.50 AKC Recording Fee & \$3.00 Event Service Fee for each 1st entry & for each additional entry of the same dog in regular & non-regular recordable single entry classes.

ENTRIES CLOSE . . . 12 NOON, WEDNESDAY, DECEMBER 21, 2011 at the address of the Show Secretary, after which time entries cannot be accepted, changed or canceled.

MAKE CHECKS & MONEY ORDERS PAYABLE TO: Cindy O'Hare, DSBD

MAIL ALL ENTRIES WITH FEES to Cindy O'Hare, DSBD, 8221 Griffith Ave NW, Maple Lake, MN 55358. Entries received without fees and/or mailed entries received with credit card charges will not be accepted.

ENTRIES WILL NOT BE ACCEPTED WITHOUT FEES.

FAX ENTRIES FOR THIS SHOW WILL BE ACCEPTED UP TO THE CLOSING TIME AND DATE. The Fax Entry number is 320-963-6087. Official AKC Entry Forms must be used and both sides of the entry form must be transmitted. Credit Card issuer's name (**Visa or Master Card only**), credit card number, expiration date, cardholder's name, and signature must appear on a cover page. As of January 1, 2004, the Fax Entry System fee is \$2.50 per class per show in addition to entry fees. **All entries, regardless of method of submission, using a credit card as a method of payment will be processed through the Fax Entry System and are charged the additional fee.** Proof of transmission is not proof of receipt of a legible or complete transmission.

CANADIAN EXHIBITORS MAKE CHECKS PAYABLE IN U.S. FUNDS.

CONFIRMATION OF ENTRY & JUDGING PROGRAM will be sent (via First Class USPS mail) to the address list on the Official AKC Entry Form, as per *AKC Rules and Regulations*. **E-MAIL CONFIRMATION NOTICES WILL NOT BE SENT.** If you need information regarding your entry . . . please phone 320-963-7705.

FOR RELIABLE OVERNIGHT ENTRIES . . . PLEASE USE . . . FED-EX, UPS, or USPS

. . . for additional Premium Lists, Entry Forms, Judging Programs, & news, visit . . .
http://www.dogshowsbydesign.com

"Effective January 1, 2010
All dogs must be individually registered with either the AKC or a foreign registry organization whose pedigrees are acceptable for AKC registration in order to participate in any AKC Conformation, Performance, or Companion event. "

OFFICIAL AMERICAN KENNEL CLUB ENTRY FORM

St. Paul Dog Training Club, Inc.
219 - 13th Avenue South, South St. Paul, MN 55075

Friday, January 6, 2012

		FRIDAY
Obedience - First Entry (<i>each day</i>)	\$25.00	[]
Obedience - Additional Entry (<i>for the same dog . . . each day</i>)	\$18.00	[]
<i>The above entry fees include \$0.50 AKC Recording Fee & \$3.00 Event Service Fee for each recordable entry of the same dog in single entry classes</i>		

ENTRIES CLOSE . . . 12 NOON . . . WEDNESDAY . . . DECEMBER 21, 2011

Make Checks payable to: CINDY O'HARE, SHOW SECRETARY, DSBD
Mail to: Cindy O'Hare, 8221 Griffith Ave NW, Maple Lake, MN 55358

Conditional, unsigned, or incomplete entries or entries received without fees will not be accepted. Telephone, telegraph & email entries are not acceptable. All cancellations must be written and received by the Show Secretary before the closing date.

I ENCLOSE \$ for entry fees I ENCLOSE \$ for Catalogs

Please typewrite or print with black ink. **IMPORTANT** - Read carefully instructions on reverse side before filling out. Numbers in boxes indicate sections of the instructions relevant to the information needed in that box.

BREED	VARIETY [1]	SEX (circle one) Dog Bitch
OBEDIENCE TRIAL REGULAR CLASSES . . . offered for each trial (check classes to be entered)		OB Jmp Hgt
<input type="checkbox"/> Novice A <input type="checkbox"/> Novice B <input type="checkbox"/> Open A <input type="checkbox"/> Open B <input type="checkbox"/> Utility A <input type="checkbox"/> Utility B		
OBEDIENCE TRIAL OPTIONAL TITLING CLASSES . . . offered for each trial (check classes to be entered)		
<input type="checkbox"/> Beginner Novice A <input type="checkbox"/> Beginner Novice B <input type="checkbox"/> Grad Novice <input type="checkbox"/> Grad Open <input type="checkbox"/> Versatility		

FULL NAME OF DOG

<input type="checkbox"/> AKC REG. NO. (Enter number here)	DATE OF BIRTH
<input type="checkbox"/> C.P. NO.	PLACE OF BIRTH <input type="checkbox"/> USA <input type="checkbox"/> Canada <input type="checkbox"/> Foreign (Do not print in catalog)
<input type="checkbox"/> I.L.P./PAL NO.	
<input type="checkbox"/> FOREIGN REG. NO. & COUNTRY	

BREEDER

SIRE

DAM

ACTUAL OWNER(S) [4] _____ (Please Print)
OWNER'S ADDRESS _____
CITY _____ STATE _____ ZIP _____

NAME OF OWNER'S AGENT (IF ANY) AT THE SHOW

I CERTIFY that I am the actual owner of the dog, or that I am the duly authorized agent of the actual owner whose name I have entered above. In consideration of the acceptance of this entry, I (we) agree to abide by the rules and regulations of The American Kennel Club in effect at the time of this event, and by any additional rules and regulations appearing in the premium list for this event, and further agree to be bound by the "Agreement" printed on the reverse side of this entry form. I (we) certify and represent that the dog entered is not a hazard to persons or other dogs. This entry is submitted for acceptance on the foregoing representation and Agreement. I (we) agree to conduct myself (ourselves) in accordance with all such Rules and Regulations (including all provisions applying to discipline) and to abide by any decisions made in accord with them. I (we) certify and represent that the dog entered is not a hazard to persons or other dogs.

SIGNATURE of owner or his agent
duly authorized to make this entry _____

TELEPHONE# _____

EMAIL _____

SHOW SITE

Sorry . . . parking spaces are not available for RV's at these trials.

DIRECTIONS TO ST. PAUL DOG TRAINING CLUB

From the North: Take 1-94 to Hwy 52. Turn south on Hwy 52 to Southview Blvd. Exit left onto Southview to stop sign. Turn right at the stop sign (you'll still be on Southview) to Southview Shopping Center (between 12th & 13th Ave.) St Paul Dog Training Club is located between Synders drug and Knowlans.

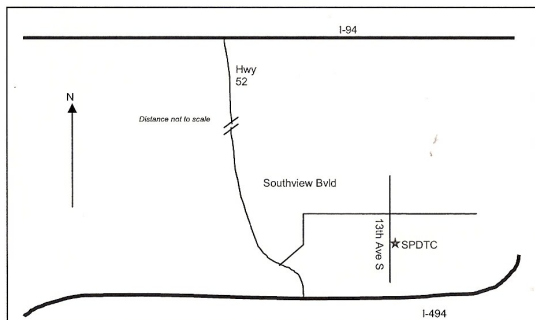

St. Paul Dog Training Club Parking

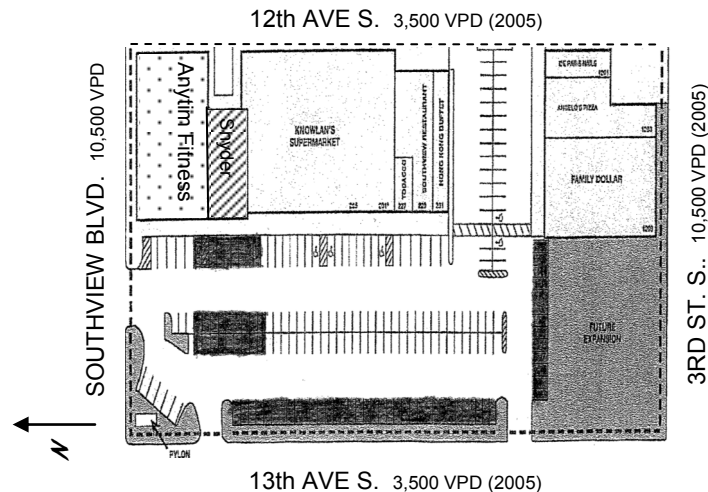

13th AVE.—no parking on west side of street. Parking on east (closer) side ok.
NOTE: NEW PARKING PLAN. No parking in the two closest aisles, in front of Knowlan's Grocery Store Entrance all the way out to the curb, or in front of the Dollar Store. Parking is allowed behind the building.

RIBBON AND ROSETTE PRIZES

First Place	Blue Ribbon
Second Place	Red Ribbon
Third Place	Yellow Ribbon
Fourth Place	White Ribbon
Highest Scoring Dog in Regular Classes	Blue & Gold Rosette
Highest Combined Score in Open B & Utility	Blue & Green Rosette
Each dog with a Qualifying Score in a Regular Obedience Class	Dark Green Ribbon

AWARDS

"Dog" when applied here means either sex.
 A dark green qualifying ribbon will be awarded to each dog attaining a qualifying score.
 Unless otherwise indicated, all ribbons, rosettes, trophies and awards are offered by the St. Paul Dog Training Club, Inc.

St Paul Dog Training Club will offer a NEW TITLE Rosette to each dog/handler team earning a new title at these trials.

OBEDIENCE TRIAL

HIGHEST SCORING DOG IN REGULAR CLASSES

\$50.00 Cash and Rosette
 offered by St. Paul Dog Training Club, Inc.

HIGHEST COMBINED SCORING DOG IN OPEN B & UTILITY

\$50.00 Cash and Rosette
 offered by St. Paul Dog Training Club, Inc.

First - Fourth Places . . . in all regular & optional titling classes Dog Treats

FOR ALL TRIALS . . .

THE CLUB, RESERVES THE RIGHT to substitute trophies with ones of equal or greater value.

SHOW SITE HOURS

Please refer to your Judging Program for exact rings times and class order or visit www.dogshowsbydesign.com for news!

The building will be open from 7:00 AM on Friday, January 6, 2012 for exhibitors to set-up crates and equipment.

ACCOMMODATIONS

By listing the following hotels/motels, there is not certainty that dogs will be accepted in rooms. Please ask and verify pet policy when making reservations.

- Red Roof Inn Woodbury** (dog accepted)
 Exit 60 - I-494 & Valley Creek Road - Woodbury, MN 1-(800) 843-7663 or 612-738-7160
- Holiday Inn Express - Woodbury** (small dogs welcome)
 Exit 251 - I-94 - Woodbury, MN 651-702-0200
- Excel Inn of St. Paul** (small dogs welcome)
 I-94 & White Bear Avenue - Maplewood, MN 651-771-5566
- Wingate Inn - Oakdale**
 I-694 & Cty. 10 - Oakdale, MN 651-578-8466

Food Service will not be available at this trial.